

# Mandatory Disclosure Format

*(The following information shall be displayed by the Institution concerned on its own website for the information of all concerned as per provision of Regulation 7(10) and 8(16) of the NCTE (Recognition Norms & Procedure) Regulations, 2007*

## 1. Details of the institution:

- 1.1 Name of the Institution : Mahatma Education Society's Pillai College of Education & Research
- 1.2 Date of Establishment: July 2007
- 1.3 Complete postal address: Dr. Pillai's Teacher Training & Research Centre,  
Sector – 8 , Khanda Colony , New Panvel ,  
P.O. : Panvel Block ---  
Tehsil/Taluka : Panvel Town/City : New Panvel  
District : Raigad State: Maharashtra Pin : 410206
- 1.4 Phone (with STD code): 022- 27480289, 27464161
- 1.5 Fax: 022 - 27464161
- 1.6 E-mail: senos@mes.ac.in
- 1.7 Website Address: www.pcerpanvel.ac.in
- 1.8 Nearest Railway Station : Panvel Railway Station
- 1.9 Nearest Town : Panvel
- 1.10 Type of Institution (Boys/Girls/Co-Education) : Co - Education
- 1.11 Status of Institution (Minority/Non-Minority) : Minority

## 2. Management:

- 2.1 Government owned: -----
- 2.2 Govt.aided: -----
- 2.3 Self-financed: Self Financed
- 2.4 University Department: -----
- 2.5 Any other (please specify): Affiliated to University of Mumbai

**3. Details of the course applied for**

|     |   |  |
|-----|---|--|
| 3.1 | Level of the Course                                       | Under Graduation and Post Graduation   |
| 3.2 | Name of the Teacher                                       |  |
|     | Education Course  | B.Ed. and M.Ed.  |
| 3.3 | Duration of the Course                                    | B.Ed. - Two Years<br>M.Ed. – Two Years   |
| 3.3 | Whether to be conducted in face to face or distance mode. | Regular  |
| 3.4 | Proposed Intake   | 100 – B.Ed.<br>50 – M.Ed.  |
| 3.5 | Academic Session from which the course will be conducted  | July - May   |
| 3.5 | Details of the Affiliating Body                           |  |
|     | Name  | University of Mumbai   |
|     | Address/Tel/Fax No.                                       | Ranade Bhavan, Vidyanagari<br>Santacruz(E), Mumbai – 400098<br>PH : 022 – 26526388<br>FAX : 022 - 22673579 |

**4. Land:**

|     |  |  |     |    |
|-----|--|--|-----|----|
| 4.1 | Whether copy of the Affidavit in the prescribed format has been displayed on the website as required under Regulation 8(9) of the NCTE Regulations, 2007 | <table border="1"><tr><td>Yes</td><td>No</td></tr></table> | Yes | No |
| Yes | No   |  |     |    |
| 4.2 | Land Identification (Plot/Khasra No.)  | Plot No. 1, Khanda Colony ,<br>New Panvel                  |     |    |
| 4.2 | Land Area in sq mt.  | 4401.52 Sq. mts  |     |    |
| 4.2 | Whether the Title of the land is on Ownership basis  | Leased to Mahatma Education Society                        |     |    |
| 4.3 | Title of the land is on lease as per law   | YES  |     |    |

---

- 4.4 Duration of the lease 60 years
- 4.5 Land Use Certificate obtained  
for Educational Institution YES

5. **Manpower (Photographs of Teaching Faculty should be displayed)**

- 5.1 Details of proposed/appointed teaching staff  
(Date of birth, Qualification, Professional Qualification, and other relevant information)
- 5.2 Details of proposed/appointed non-teaching staff

6. **Building**

- |  | <b>Yes</b>                          | <b>No</b>                           |
|--|-------------------------------------|-------------------------------------|
| 6.1 Construction of the building is complete | <input checked="" type="checkbox"/> | <input type="checkbox"/>            |
| 6.2 Building is yet to be constructed        | <input type="checkbox"/>            | <input checked="" type="checkbox"/> |
| 6.3 Building is fire safety-proof            | <input checked="" type="checkbox"/> | <input type="checkbox"/>            |
| 6.4 Building is disabled friendly            | <input checked="" type="checkbox"/> | <input type="checkbox"/>            |
| 6.5 Common room for boys/girls available     | <input checked="" type="checkbox"/> | <input type="checkbox"/>            |
| 6.6 Date of completion of the Building       |                                     |                                     |
| 6.7 Covered Area in sq mt.                   | 2000 sq. mt                         |                                     |
| 6.8 Number of classrooms                     | 12                                  |                                     |

7. **Library:**

- |  |   |  |
|--|---|--|
| 7.1 The Library has separate reference section/<br>Journals section and reading room | <input checked="" type="checkbox"/> Yes |  |
| 7.2 Number of books in the library   | 13,976                                  |  |
| 7.3 Total number of educational<br>Journals/periodicals being subscribed             | 55                                      |  |
| 7.4 Number of encyclopedias available in the library                                 | 18                                      |  |
| 7.5 Number of books available in the reference section<br>of the library             | 1500                                    |  |
| 7.6 Seating capacity of the reading room of the library                              | 110                                     |  |

8. **Instructional Facilities**

- 8.1 Details of laboratories available(pl attach annexure)
- 8.2 Arrangement made for practice teaching YES
- 8.3 Number and Name of school(s) for practice teaching 10 ( List of the Schools attached )

9. **Facilities for games & sports:**

- 9.1 Own Playground
- 9.2 Playground of another institution on sharing basis
- 9.3 Gymnasium/Multipurpose hall
- 9.4 Facilities for gymnasium
- 9.5 Facilities for athletics
- 9.6 Facilities for Indoor Games
- 9.7 Facilities for Outdoor Games

| Yes | No |
|-----|----|
|     | √  |
| √   |    |
| √   |    |
| √   |    |
| √   |    |
| √   |    |
| √   |    |

10. **Other facilities available:**

- 10.1 Canteen facilities available or not
- 10.2 Medical facilities available or not
- 10.3 Hostel facilities available or not

| Yes | No |
|-----|----|
| √   |    |
| √   |    |
| √   |    |

**Note: This is the minimum information to be provided. Institutions however may like to add further inputs for information of stakeholders.**

### **LIST OF SCHOOLS**

| <b>Sr. No.</b> | <b>Name of the School</b>                                   | <b>Place</b>  | <b>Telephone No.</b> |
|----------------|---|---------------|----------------------|
| 1.             | St. Joseph High School                                      | Kalamboli     | 27422973 / 127       |
| 2.             | Changu Khana Thakur Vidyalaya                               | New Panvel    | 27459011             |
| 3.             | K.A. Banthiya Vidyalaya                                     | New Panvel    | 27452353             |
| 4.             | K.V. Kanya Vidyalaya  | New Panvel    | 27452424             |
| 5.             | St. Joseph Vidyalaya  | New Panvel    | 27422127             |
| 6.             | V.K.Vidyalaya   | New Panvel    | 27452300             |
| 7.             | New Horizon Public School                                   | Khanda Colony | 64156969             |
| 8.             | Sudhagarh High School                                       | Kalamboli     | 32580496             |
| 9.             | Agresikshan Sanstha Madhyamik Vidyalaya                     | Khanda Colony | 9869575352           |
| 10.            | Vasudev Balwant Phadke Vidhyala                             | New Panvel    | 27464284             |
| 11.            | New English School ( English / Marathi Medium) D.G. Tatkare | Kalamboli     | 27426841             |
| 12.            | Mahatma School of Academics & Sports                        | Khanda Colony | 27454285/ 27453050   |
| 13.            | Karnala sports  | Panvel        |                      |
| 14.            | Mahatma International School                                | Khanda Colony | 27454285             |

100Rs.



महाराष्ट्र MAHARASHTRA

विक्रीचे ठिकाण :- एन.एल. ५/२ सेक्टर ३, नेरुळ 226739

अनुक्रमांक. 1672 किंमत रुपये 100/-

नांव Mahatma Education Society

हस्त... S. R. Shaware

- 8 FEB 2005

3 FEB 2005

*S. R. Shaware*

*Prakash*

दिनांक..... (प्रकाश हे कुमल डेम्बेला)

मुद्रांक विक्रेता परवाना क्र. ५/१२८९.

दूरध्वनी : ७७०७५२५, ७७०७३७९

### LEASE DEED

BETWEEN

CITY AND INDUSTRIAL DEVELOPMENT CORPORATION

OF MAHARASHTRA LTD

AND

MAHATMA EDUCATION SOCIETY

|           |
|-----------|
| प व ल     |
| १५/२/२००५ |
| २/१०      |

*Mandy*  
Estate Officer  
CIDCO LTD., CIDCO Bhavan  
Navi Mumbai - 400 614.



Secretary Society

**SCHEDULE**

ALL THAT piece or parcel of land known as plot No. One Sector - B by  
 admeasurement 4401-52 square metres or thereabout in the Eight  
 sector of the layout of land situated lying and being at village New Panvel Taluka Panvel  
 District and sub district Raigad bounded as follows. :

- On the North by : Sector 6
- On the East by : Open space
- On the South by : Play ground Plot No. 2 & 3
- On the West by : 20 Mts. wide Road.

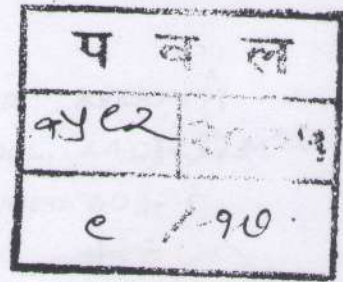

SIGNED AND DELIVERED FOR )  
 And on behalf of the city & )  
 INDUSTRIAL DEVELOPMENT CORPORA )  
 OF MAHARASHTRA LTD, Lessor by M/I )  
 The hand of Shri )  
 In the Shri. S.L. Bhosle )

*[Signature]*  
**Estate Officer**  
 CIDCO LTD., CIDCO Bhavan,  
 Navi Mumbai - 400 614.

Presence of )  
 1) Shri. G.D. Mhatre )  
 2) Shri. V.L. Mhatre )

SIGNED AND DELIVERED FOR )  
 CO-OPERATIVE HOUSING SOCIETY LTD., )  
 Lessor by the hand of )

Shri Dr. K.M. Basulekar Pillai )  
 in the Presence of )  
 1) Shri. G.D. Mhatre )  
 2) Shri. V.L. Mhatre )

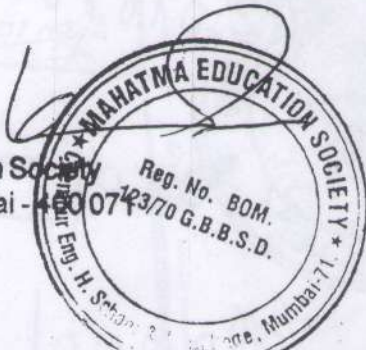

SIGNED SEALED AND DELIVERED FOR )  
 and on behalf of confirming )  
 Party Shri. SANJAY. R. CHAWAN )

By hand of Shri )  
 In the presence of )  
 1) Shri. G.D. Mhatre )  
 2) Shri. V.L. Mhatre )



61C

|         |
|---------|
| प व ल   |
| 992 004 |
| 90 - 90 |

PLAN OF PLOT FOR SCHOOL AND PLAY-GROUND PLOT NO. ...  
AT NEWRAVEL (WEST)

ADJ. SECTOR - 6

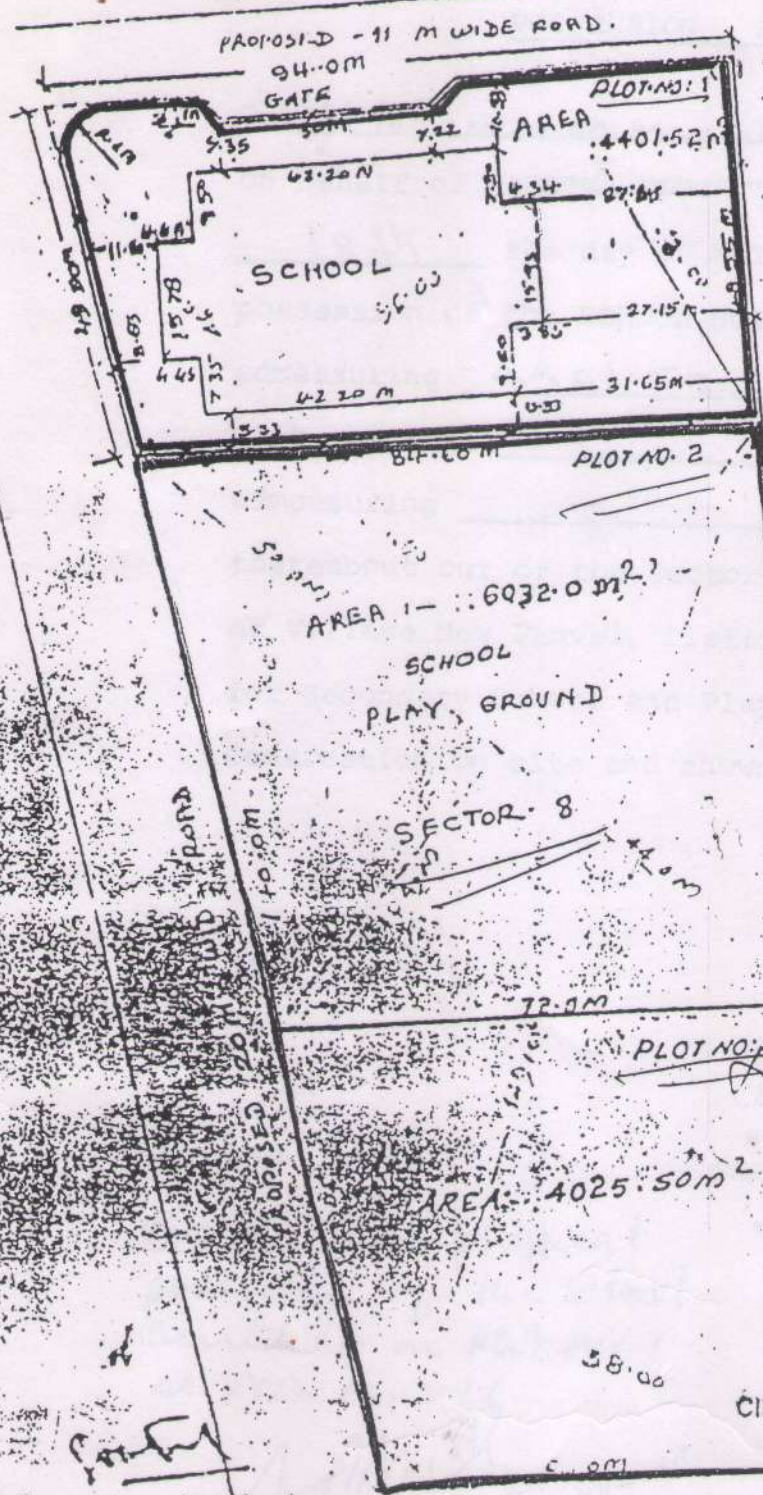

PLOT AREA : 4511.0  
DEDUCT FOR CURVE: 11.0  
" " PARKING: 99.0  
SCHOOL PLOT AREA: 4401.52

| PLOT NO. | USER        | AREA (M <sup>2</sup> ) |
|----------|-------------|------------------------|
| 1        | SCHOOL      | 4401.52 M <sup>2</sup> |
| 2        | PLAY GROUND | 6031.0                 |
| 3        | —           | 4025.50                |

4401  
6030  
-----  
10030

CONFIRMED

DATE: 26/6/89

SENIOR PLANNER (S)

ADDL. CHIEF



Estate Officer  
CIDCO LTD, CIDCO Bhavan,  
Navi-Mumbai - 400 614.

PROPOSED 11 M WIDE ROAD

SCALE: 1:1000

APPROVED ON 19.05.89 AS PER DIRECTION

DATED 14th May 1989

PLAN PREPARED BY: [Signature]







MES' PILLAI COLLEGE OF EDUCATION AND RESEARCH, NEW PANVEL (w)

## MES' PILLAI COLLEGE OF EDUCATION AND RESEARCH,

Plot 1, Khanda Colony, Sector 8, New Panvel (w), Raigad, Maharashtra

### Staff profile

| Sr. No. | Name and Designation of Teaching Faculty | Qualification  | Approval Letter No.         | Photo   |
|---------|--|--|-----------------------------|---|
| 1       | Dr. Sally Enos<br>Principal              | M.Sc., M.Ed., Ph.D<br>(Edu)., NET(Edu)                               | CONCOL/SA/992/2009          |    |
| 2       | Dr. Pratima Pradhan Asst. Prof.          | B.Ed. 55%<br>M.A.(Edu) 60%<br>M.A(Soc) 65%<br>Ph.D (Edu)<br>NET(Edu) | CONCOL/SA/5628<br>of 2010   |    |
| 3       | Dr. Bhavna S. Dave<br>Asst Prof          | M.A., M.Ed., SET,<br>Ph.D. (Edu)                                     | CONCOL/SA/3021 of 2011      |   |
| 4       | Mrs. Geeta S. Thakur<br>Asst Prof        | B.Sc., M.Ed., SET<br>(Edu)   | CONCOL/SA/3021 of 2011      |  |
| 5       | Ms. Namrata Saxena<br>Asst. Prof.        | M.Sc. 61%<br>M.Ed. 68.57%<br>NET                                     | CONCOL/SA/6594 of 2011      |  |
| 6       | Ms. Bindu S Tambe<br>Asst. Prof.         | M.Sc.- 63%<br>M.Ed. 76%<br>NET, SET                                  | CONCOL /ICM/26322 of 2014   |  |
| 7       | Dr.Latha Venkataraman<br>Asst.Prof.      | M.Com. 47%,<br>M.A.(Eco.), MBA,<br>Ph.D(Edu)                         | TAAS (CT)/ICD/2015-16/51825 |  |
| 8       | Ms. Pradnya P Jadhav<br>Asst. Prof.      | M.A 50%<br>M.Ed. 65%<br>SET  | TAAS/(CT) ICD/2015-16/51825 |  |
|         |  |  |                             |   |

|    |   |  |                             |   |
|----|---|--|-----------------------------|---|
| 9  | Mr. Satish Shinde<br>Asst Prof<br>(Physical<br>Education) | B. Com., M. P. Ed.                             | CONCOL/SA 5086 of 1997      |  |
| 10 | Mr.<br>Gyanendrapratap<br>Singh                           | M.Sc. M.Ed. NET                                |                             |   |
| 11 | Ms Navneet<br>Sandhu Librarian                            | B.Com. 45%<br>M. Lib. 60.25%<br>M.Phil.<br>NET | CONCOL/IS/ECD/2014-15/47149 |  |
| 12 | MS. Arachana<br>Mokal                                     | M.Lib  |                             |   |

F.No. WRC/APW02767/123344/2015

1148286

Date: 31.5.15

**TO BE PUBLISHED IN GAZETTE OF INDIA PART III SECTION 4**

**Revised Order**

Whereas, in exercise of the powers conferred by sub-section(2) of Section 32 of the National Council for Teacher Education Act, 1993(73 of 1993), and in supersession of the National Council for Teacher Education [Recognition Norms and Procedure] Regulations, 2009, the National Council for Teacher Education has notified the Regulations, 2014 on 1.12.2014.

2. And whereas, the Pillai College of Education and Research, Plot No. 1, Khanda Colony, Sector 8, New Panvel, Raigad, Maharashtra by affidavit dt. 05.01.2015 has consented to come under new Regulations and sought for one basic unit in B.Ed., which require additional facilities

3. And whereas, it has been decided to permit the institution to have two basic units of 50 students each subject to the institution fulfilling following conditions namely,

- I. The institution shall create additional facilities that include (a) additional built-up area, (b) additional infrastructure, (c) additional funds, (d) additional staff as per Regulations, 2014 and inform Regional Committees with required documents by October 31, 2015.
- II. The applicant-institution for additional unit will be required to submit the required documents such as land documents, Encumbrance Certificate (EC), Land Use Certificate (LUC), Building Plan (BP) and the Approved Staff List in the specified proforma available on the website to the Regional Committee in proof of having provided additional facilities before October 31, 2015. Building Completion Certificate (BCC) may be given along with other documents if available, otherwise it can also be given to the Visiting team at the time of inspection.
- III. The Regional Committees shall arrange for verification of documents, inspection of these premises and check adherence to these conditions by 20 Feb, 2016. If it is found by the Regional Committee that the institution fails to comply with these requirements, the institutions shall not be permitted to admit students for the academic year 2016-2017.
- IV. In case any existing institution's matter is sub-judice under court direction/SCN under section 17 of the NCTE Act/Complaint etc., the institution shall be required to submit a copy of the Hon'ble Court order/reply to SCN/complaint/already submitted alongwith the documents, if any together the documents referred above. In case the institution's request for shifting of premises is pending, such institutions shall be required to submit the requisite documents as per provisions of the NCTE Regulations, 2014 with a copy of the order/NOC of the affiliating body/State Govt. and such other documents as indicated in the revised format recognition order. The final decision shall be subject to the directions given by the Hon'ble Court in the Writ Petition/case decided by the Western Regional Committee in respect of Section 17/complaint cases etc.

4. Now therefore, in the light of the above and in accordance with the **NCTE Regulations, 2014, the Western Regional Committee (NCTE) hereby issues the revised recognition order to Pillai College of Education and Research, Plot No. 1, Khanda Colony, Sector 8, New Panvel, Raigad, Maharashtra for conducting B.Ed programme of two years duration with an annual intake of 100 students (two basic units of 50 students each) from the academic session 2015-16 subject to fulfillment of the conditions mentioned herein before 31.10.2015.**

Cont.....2

5. Further, the recognition is subject to fulfillment of other requirements as may be prescribed by other regulatory bodies like UGC, affiliating University/Body, the State Government etc, as applicable. The affiliating body (University/State Govt.) shall also be required to verify the authenticity of the land & building documents as well as appointment of requisite teaching & non-teaching staff as per provisions of the NCTE Regulations, 2014 by the concerned institution before grant of affiliation to an institution.

6. The institution shall submit to the Regional Committee a Self- Appraisal Report at the end of each academic year along with the statement of annual accounts duly audited by a chartered Accountant.

7. The institutions shall maintain & update its web-site as per provisions of NCTE Regulations and always display following as mandatory disclosure:-

- a) Sanctioned programmes along with annual intake in the institution:
- b) Name of faculty and staff in full as mentioned in school certificate along with their qualifications, scale of pay and photograph.
- c) Name of faculty members who left or joined during the last, quarter:
- d) Names of Students admitted during the current session along with qualification, Percentage of marks in the qualifying examination and in the entrance test, if any, date of admission, etc.;
- e) Fee charged from students;
- f) Available infrastructural facilities;
- g) Facilities added during the last quarter;
- h) Number of books in the library, journals subscribed to and additions, if any, in the last quarter;
- i) The affidavit with enclosure submitted along with application.
- j) The institution shall be free to post additional relevant information. if it so desires.
- k) Any false or incomplete information on website shall render the institution liable for withdrawal of recognition.

If institution contravenes any of the above conditions or the provision of the NCTE Act, Rules, Regulations and orders made and issued there under, the institution will render itself liable to adverse action including withdrawal of recognition by the Regional Committee under the provisions of Section 17(1) of the NCTE Act 1993.

8. Recognition order no. WRC/5-6/107/2008/42818-42823 dt. 12.09.2008 & order no. WRC/5-6/108/2008/44941 dt. 07.10.2008 be treated as cancelled from the date of issue of this revised order.

By Order,

  
(Sunil Shrivastava)  
Regional Director

The Manager,  
Government of India Press  
Department of Publications (Gazette Section)  
Civil Lines, New Delhi - 110054.

Copy to:

- ✓ 1. The Principal, Pillai College of Education and Research, Plot No. 1, Khanda Colony, Sector 8, New Panvel, Raigad, Maharashtra.
2. The Secretary, Mahatma Education Society, Plot No. 1, Khanda Colony, Sector 8, New Panvel, Raigad, Maharashtra
3. The Registrar, University of Mumbai, University Road, Fort, Mumbai-400032, Maharashtra.
4. The Education Secretary, (Higher Education), Govt. of Maharashtra, Mantralaya, Mumbai, Maharashtra.
5. The Secretary, Dept. of School Education and Literacy, Ministry of Human Resource Development, Govt. of India, Shastri Bhavan, New Delhi - 110 001.
6. The Member Secretary, National Council for Teacher Education, Hans Bhawan, Wing-II, 1, Bahadurshah Zafar Marg, New Delhi-110 002.
7. The Computer Programmer, Computer Section, WRO, (NCTE), Bhopal with a request to include the name of the institution in the recognized list uploaded in WRC website.
8. Office Order file/institution no. APW02767/123344.

Regional Director

राष्ट्रीय अध्यापक शिक्षा परिषद्  
(भारत सरकार का एक विधिक संस्थान)  
पश्चिम क्षेत्रिय समिति



National Council For Teacher Education  
(A Statutory Body of the Government of India)  
Western regional Committee

F. No. WRC/APW06392/125132/2015

Date: 05.12.2015

TO BE PUBLISHED IN GAZETTE OF INDIA PART III SECTION 4

Revised Order

Whereas, in exercise of the powers conferred by sub-section(2) of Section 32 of the National Council for Teacher Education Act, 1993(73 of 1993), and in supersession of the National Council for Teacher Education [Recognition Norms and Procedure] Regulations, 2009, the National Council for Teacher Education has notified the Regulations, 2014 on 01.12.2014.

2. And whereas, the Mahatma Education Society Pillai College of Education and Research, Pillai Teachers Training & Research Centre, Plot No. 1, Sector-8, New Panvel, Tal. Panvel, Dist. Raigad, Maharashtra by affidavit dt.05.01.2015 has consented to come under new Regulations and sought for one basic unit in M.Ed. which require additional facilities

3. And whereas, it has been decided to permit the institution to have one basic unit of 50 students subject to the institution fulfilling following conditions namely,

- i. The institution shall identify/select the full component of the faculty/staff, as per NCTE Regulations, 2014, and approval of the affiliating body be obtained latest by 29.02.2016 and the same may be conveyed to the Western Regional Committee in the prescribed manner and in the prescribed proforma, giving details of qualification and experience of the Faculty/Staff selected alongwith the letter of approval of the affiliating body by that date.
- ii. The institution shall create additional facilities that include (a) additional built-up area, (b) additional infrastructure, (c) additional funds, as per Regulations, 2014 and inform the Regional Committee with required documents such as certified copy of registered land documents, Certificate for Land Use (CLU), copy of approved Building Plan (BP) and Encumbrance Certificate (EC) in proof of having the additional facilities, before May 30, 2016. Building Completion Certificate (BCC) may be given along with other documents if available, otherwise it can be given to the Visiting team at the time of inspection.
- iii. In case any existing institution's matter is sub-judice under court direction/SCN under section 17 of the NCTE Act/Complaint etc., the institution shall be required to submit a copy of the Hon'ble Court order/reply to SCN/complaint/already submitted alongwith the documents, if any together the documents referred above. In case the institution's request for shifting of premises is pending, such institutions shall be required to submit the requisite documents as per provisions of the NCTE Regulations, 2014 with a copy of the order/NOC of the affiliating body/State Govt. and such other documents as indicated in the revised format recognition order. The final decision shall be subject to the directions given by the Hon'ble Court in the Writ Petition/case decided by the Western Regional Committee in respect of Section 17/complaint cases etc.

4. Now therefore, in the light of the above and in accordance with the NCTE Regulations, 2014, the Western Regional Committee (NCTE) hereby issues the revised recognition order to Mahatma Education Society Pillai College of Education and Research, Pillai Teachers Training & Research Centre, Plot No. 1, Sector-8, New Panvel, Tal. Panvel, Dist. Raigad, Maharashtra for conducting M.Ed programme of two years duration with an annual intake of 50 students (one basic unit of 50 students) from the academic session 2015-16 subject to fulfillment of the conditions mentioned above.

5. Further, the recognition is subject to fulfillment of other requirements as may be prescribed by other regulatory bodies like UGC, affiliating University/Body, the State Government etc, as applicable. The affiliating body (University/State Govt.) shall also be required to verify the authenticity of the land & building documents as well as appointment of requisite teaching & non-teaching staff as per provisions of the NCTE Regulations, 2014 by the concerned institution before grant of affiliation to an institution.

Cont.....2

मानस भवन, श्यामला हिल्स, भोपाल-462002

Manas Bhawan, Shyamla Hills, Bhopal-462002

दुरभाष/ Phone: 0755-2739672, 2660915, 2660379, 2660372 फेक्स/ Fax: 0755-2660912

Email: wrc@ncte-india.org Website : www.nctewrc.co.in  
NCTE HQrs. Website : www.ncte-india.org

6. The institution shall submit to the Regional Committee a Self-Appraisal Report at the end of each academic year along with the statement of annual accounts duly audited by a chartered Accountant.

7. The institutions shall maintain & update its web-site as per provisions of NCTE Regulations and always display following as mandatory disclosure:-

- a) Sanctioned programmes along with annual intake in the institution;
- b) Name of faculty and staff in full as mentioned in school certificate along with their qualifications, scale of pay and photograph.
- c) Name of faculty members who left or joined during the last quarter;
- d) Names of Students admitted during the current session along with qualification, Percentage of marks in the qualifying examination and in the entrance test, if any, date of admission, etc.,
- e) Fee charged from students;
- f) Available infrastructural facilities;
- g) Facilities added during the last quarter;
- h) Number of books in the library, journals subscribed to and additions, if any, in the last quarter;
- i) The affidavit with enclosure submitted along with application;
- j) The institution shall be free to post additional relevant information, if it so desires.
- k) Any false or incomplete information on website shall render the institution liable for withdrawal of recognition.

If institution contravenes any of the above conditions or the provision of the NCTE Act, Rules, Regulations and orders made and issued there under, the institution will render itself liable to adverse action including withdrawal of recognition by the Regional Committee under the provisions of Section 17(1) of the NCTE Act 1993.

8. Recognition order no. WRC/5-6/107<sup>th</sup>/2008/43506-43511 dt.16.09.2008, WRC/APW06392/125132/140/2010/83094 dt. 22.11.2011 be treated as cancelled from the date of issue of this revised order.

By Order,

(Satish Gupta)  
Regional Director

The Manager,  
Government of India Press  
Department of Publications (Gazette Section)  
Civil Lines, New Delhi - 110054.

Copy to:

1. The Principal, Mahatma Education Society Pillai College of Education and Research, Pillai Teachers Training & Research Centre, Plot No. 1, Sector-8, New Panvel, Tal. Panvel, Dist. Raigad, Maharashtra.
2. The Secretary, Mahatma Education Society, Chembur Naka, Mumbai, Maharashtra.
3. The Registrar, University of Mumbai, Mumbai, Maharashtra.
4. The Education Secretary, (Higher Education), Govt. of Maharashtra, Mantralaya, Mumbai, Maharashtra.
5. The Secretary, Dept. of School Education and Literacy, Ministry of Human Resource Development, Govt. of India, Shastri Bhavan, New Delhi - 110 001.
6. The Computer Programmer, Computer Section, WRO, (NCTE), Bhopal with a request to include the name of the institution in the recognized list uploaded in WRC website.
7. Office Order file/Institution no. APW06392/125132.

  
Regional Director

|   |
|---|
| <b>MES' PCEIT NEW PANVEL</b>  |
| INWARD/RECEIVED No. _____   |
| Accepted by date <u>10.12.15</u>  |
| Received by  |



GOVERNMENT OF MAHARASHTRA  
ADMISSIONS REGULATING AUTHORITY, MUMBAI.



9th Floor, New Excelsior Building  
A.K. Nayak Marg, Fort, Near CSMT,  
Mumbai - 400 001 (M.S.)

Tele No.: 022 - 2201 6159  
Website: <http://www.maha-ara.org>  
E-mail: [maharashtra.ara@gmail.com](mailto:maharashtra.ara@gmail.com)

Ref.No: ARA/APPROVAL/2019-20/CR.01 /242

Date: 28/05/2020

TO,  
The Dean/Principal,  
041524721021 - PILLAI COLLEGE OF EDUCATION AND RESEARCH, NEW PANVEL

**Subject: Approval of provisional admissions granted by your Institute in Course –  
B.Ed. for Academic Year 2019-20.**

**Ref. :Minutes of the Meeting of Admissions Regulating Authority held in Jan 2020**

Sir/Madam

The Authority has received a proposal for Approval of Admission of candidates provisionally admitted in your Institute/College for the Academic Year 2019-20. On the basis of verification report, submitted by the concerned Directorate, the Authority has resolved in the meeting held in Jan 2020, which is published on the website of ARA. Accordingly, by the Order of Admissions Regulating Authority, Mumbai it is hereby informed that the Authority is, prima facie, satisfied as to the correctness of eligibility and data of provisionally admitted students in your college and decided to accord its approval for students in your institute for the Academic Year 2019-20 as detailed in the following table.

| No. of Students Admitted Provisionally by the college | No. of Students whose Admission is Approved by ARA | No. of Admissions Not Approved |
|---|--|--------------------------------|
| 47  | 47   | 0                              |

The names of the student approved/Not Approved is attached here with. The above admissions have been electronically scrutinized as well as physically verified. The discrepancies found during physical verification have been already informed to you.

It is, however, made clear that this approval is granted on the basis of the documents and the information supplied and made available for verification by your college. In case the information so given is found incorrect and/or in case, any illegality or irregularity caused in such admissions is brought to notice of the Authority at later point of time, it will be open for the Authority to take appropriate action in that regard.

(J P. DANGE) I.A.S., CHAIRMAN,  
ADMISSIONS REGULATING AUTHORITY AND  
FORMER CHIEF SECRETARY,  
MAHARASHTRA STATE.



(S V KADAM) I.A.S., SECRETARY,  
ADMISSIONS REGULATING AUTHORITY AND  
COMMISSIONER, STATE CET-CELL,  
MAHARASHTRA STATE.

Encl:- As Above

Copy To-

- 1) The Director, Directorate of Higher Education
- 2) The Registrar, Concerned University
- 3) Select file, Admission Regulating Authority.





## Admissions Regulating Authority, Mumbai.

Directorate Name: Directorate of Higher Education

Course Name: B.Ed.

College Code & Name: 041524721021' - PILLAI COLLEGE OF EDUCATION AND RESEARCH, NEW PANVEL

| Sr.No | Name of Candidate                     | Form No.   | Gender | Candidate Category | Seat Type Code | CAP Round | Approval Status | Subject/Branch                | Discrepancy, If any? |
|-------|---------------------------------------|------------|--------|--------------------|----------------|-----------|-----------------|-------------------------------|----------------------|
| 1     | LARISSA PEREIRA                       | 1619100079 | Female | OPEN               | 1              | 1         | Approved        | Science                       |                      |
| 2     | MARIA GERALDINE ANTHONY AMIRTHA RAJAN | 1619101149 | Female | OPEN               | 1              | 3         | Approved        | Science                       |                      |
| 3     | SHASHIKALA YADAV                      | 1619101358 | Female | OPEN               | 7              | 5         | Approved        | English                       |                      |
| 4     | ZAINAB KHOZEM MALAK                   | 1619101589 | Female | OPEN               | 1              | 5         | Approved        | English                       |                      |
| 5     | SOUMYA VARGHESE                       | 1619101793 | Female | OPEN               | 7              | 5         | Approved        | English                       |                      |
| 6     | DARSHIKA MISHRA                       | 1619101864 | Female | OPEN               | 7              | 1         | Approved        | Mathematics/ Statistics       |                      |
| 7     | SAMEERA KHAJA MIYAN SHAIKH            | 1619102106 | Female | OPEN               | 1              | 1         | Approved        | Mathematics/ Statistics       |                      |
| 8     | AMRITA SATISH TOSH SHREE              | 1619102136 | Female | OPEN               | 1              | 1         | Approved        | Science                       |                      |
| 9     | DIHANASHRI PRADIP TANDEL              | 1619102828 | Female | OPEN               | 1              | 3         | Approved        | Marathi                       |                      |
| 10    | MUKTA SHRIKANT GHATE                  | 1619102859 | Female | OPEN               | 1              | 3         | Approved        | Science                       |                      |
| 11    | POORNIMA SANJEEVA SHETTY              | 1619103026 | Female | OPEN               | 1              | 1         | Approved        | Science                       |                      |
| 12    | SAMRUDDHI AMRUT KULKARNI              | 1619103151 | Female | OPEN               | 1              | 1         | Approved        | Computer / IT / Engineering   |                      |
| 13    | PUJA DADA KHATAL                      | 1619103521 | Female | NT 2 (NT-C)        | 1              | 3         | Approved        | Computer / IT / Engineering   |                      |
| 14    | RAJIYA SAMSODDIN PINJARI              | 1619105394 | Female | OPEN               | 7              | 2         | Approved        | English                       |                      |
| 15    | CHAVAN SNEHAL JITENDRA                | 1619106322 | Female | OPEN               | 1              | 3         | Approved        | Science                       |                      |
| 16    | ANJANI BABLU JHA                      | 1619107009 | Female | OPEN               | 7              | 5         | Approved        | Mathematics/ Statistics       |                      |
| 17    | SUSMITA JOTTO MUNDA                   | 1619107647 | Female | OPEN               | 1              | 3         | Approved        | Science                       |                      |
| 18    | ARCHANA KUMARI                        | 1619107675 | Female | OPEN               | 7              | 5         | Approved        | English                       |                      |
| 19    | RUCHI KRISHANMOHAN YADAV              | 1619108323 | Female | OPEN               | 1              | 3         | Approved        | Computer / IT / Engineering   |                      |
| 20    | MAYAVATI RAJ VERMA                    | 1619108838 | Female | OPEN               | 1              | 5         | Approved        | English                       |                      |
| 21    | VRINDA RAJEEV AGARWAL                 | 1619109153 | Female | OPEN               | 1              | 1         | Approved        | Commerce / Management / Law   |                      |
| 22    | RIYA MATHEW PADINJARAPARAMBIL         | 1619109199 | Female | OPEN               | 1              | 1         | Approved        | Commerce / Management / Law   |                      |
| 23    | POOJA VENUGOPALAN NAIR                | 1619109264 | Female | OPEN               | 2              | 3         | Approved        | Commerce / Management / Law   |                      |
| 24    | CHINCHU P MATHEW                      | 1619109304 | Female | OPEN               | 7              | 1         | Approved        | English                       |                      |
| 25    | JASMIN MARIA JAMES                    | 1619109578 | Female | OPEN               | 7              | 1         | Approved        | Science                       |                      |
| 26    | JYOTI YADAV                           | 1619109951 | Female | OPEN               | 1              | 5         | Approved        | Economics                     |                      |
| 27    | SOWMIYA AJJARAPU                      | 1619112505 | Female | OPEN               | 7              | 5         | Approved        | History                       |                      |
| 28    | POONAM JAIPRAKASH UPADHYAY            | 1619112884 | Female | OPEN               | 1              | 1         | Approved        | Computer / IT / Engineering   |                      |
| 29    | SUCHITRA SASHIDHARAN PILLAI           | 1619112982 | Female | OPEN               | 1              | 5         | Approved        | English                       |                      |
| 30    | PRIYANKA KUMARI                       | 1619113630 | Female | OPEN               | 7              | 5         | Approved        | History                       |                      |
| 31    | CHANDANI KUMARI                       | 1619115797 | Female | OPEN               | 7              | 5         | Approved        | Mathematics/ Statistics       |                      |
| 32    | PREETY KUMARI                         | 1619116625 | Female | OPEN               | 7              | 5         | Approved        | Mathematics/ Statistics       |                      |
| 33    | SWETHA ELEGATE                        | 1619116719 | Female | OPEN               | 7              | 5         | Approved        | Agriculture / Medical Science |                      |
| 34    | SHILPA ANNA JOHN                      | 1619117159 | Female | OPEN               | 1              | 5         | Approved        | Social Science                |                      |
| 35    | ANNA SUSAN GEORGE                     | 1619117696 | Female | OPEN               | 7              | 1         | Approved        | Science                       |                      |
| 36    | FALGUNI RASIK SHAH                    | 1619118505 | Female | OPEN               | 7              | 5         | Approved        | Geography                     |                      |
| 37    | DIMPLEKUEVER NARAYANSINGH BALOT       | 1619118805 | Female | OPEN               | 1              | 1         | Approved        | Mathematics/ Statistics       |                      |
| 38    | VAISHNAVI SATYAJEET SALVI             | 1619122696 | Female | OPEN               | 1              | 1         | Approved        | Science                       |                      |
| 39    | DIPIKA SANTOSH GANDAL                 | 1619123102 | Female | OPEN               | 1              | 3         | Approved        | Mathematics/ Statistics       |                      |
| 40    | SNEHAL MAYA KULABKAR                  | 1619125069 | Female | OPEN               | 1              | 1         | Approved        | Science                       |                      |
| 41    | HEENA SURENDRA JAYANT                 | 1619125613 | Female | OPEN               | 1              | 3         | Approved        | Commerce / Management / Law   |                      |
| 42    | POOJA SHAILENDRA PANDEY               | 1619128158 | Female | OPEN               | 1              | 5         | Approved        | Economics                     |                      |
| 43    | DIPALI AMIT CHAUDHARI                 | 1619131129 | Female | OPEN               | 1              | 5         | Approved        | Geography                     |                      |
| 44    | NAFISA AKIL ZAVERI                    | 1619131318 | Female | OPEN               | 7              | 5         | Approved        | History                       |                      |

(J. P. DANGE) A.S., CHAIRMAN,  
ADMISSIONS REGULATING  
AUTHORITY AND  
FORMER CHIEF SECRETARY,  
MAHARASHTRA STATE.



(S. V. KADAM) I.A.S., SECRETARY,  
ADMISSIONS REGULATING  
AUTHORITY AND  
COMMISSIONER, STATE CET-  
CELL,  
MAHARASHTRA STATE.

5/28/2020

| Sr.No | Name of Candidate             | Form No.   | Gender | Candidate Category | Seat Type Code | CAP Round | Approval Status | Subject/Branch          | Discrepancy, If any? |
|-------|-------------------------------|------------|--------|--------------------|----------------|-----------|-----------------|-------------------------|----------------------|
| 45    | SUPRIYA DAS                   | 1619131439 | Female | OPEN               | 7              | 5         | Approved        | Social Science          |                      |
| 46    | SHITAL POPAT MALI             | 1619132418 | Female | ODC                | 1              | 5         | Approved        | Mathematics/ Statistics |                      |
| 47    | CHINMAYEE SHIVDAS CHAKRABORTY | 1619132612 | Female | OPEN               | 7              | 5         | Approved        | English                 |                      |

  
(J.P. DANGE) I.A.S., CHAIRMAN,  
ADMISSIONS REGULATING  
AUTHORITY AND  
FORMER CHIEF SECRETARY,  
MAHARASHTRA STATE.

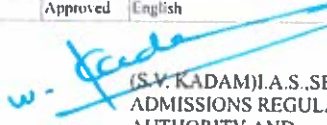

  
(S.V. KADAM) I.A.S., SECRETARY,  
ADMISSIONS REGULATING  
AUTHORITY AND  
COMMISSIONER, STATE CET-  
CELL,  
MAHARASHTRA STATE.



## Round wise Admitted Candidate List

Report

| Sr. No. | Round     | ApplicationID | CandidateName                 | AllottedType | CETRollNo  |
|---------|-----------|---------------|-------------------------------|--------------|------------|
| 1       | Round-I   | 1319101022    | ASMITA AJAY GALANDE           | OPEN-General | 2610000011 |
| 2       | Round-I   | 1319100636    | DIVYA NIKLISH WADHWA          | OPEN-General | 2610000008 |
| 3       | Round-I   | 1319100941    | ISHA ROHIT DHODY              | OPEN-General | 2610000037 |
| 4       | Round-I   | 1319101025    | JYOTIRMAYEE LENKA             | OPEN-General | 2610000014 |
| 5       | Round-I   | 1319100693    | RADHIKA HARDIK DAVE           | OPEN-General | 2700000023 |
| 6       | Round-I   | 1319100972    | RITABEN MEGHAJI BHAI MARAWADA | OPEN-General | 2700000051 |
| 7       | Round-I   | 1319100323    | SHARMILA SHAILEN PATHARE      | OPEN-General | 2610000040 |
| 8       | Round-I   | 1319100164    | UMA VINODKUMAR MISHRA         | OPEN-General | 2610000001 |
| 9       | Round-III | 1319101146    | SONI KUMARI                   | OPEN-General | 2700000025 |
| 10      | Round-III | 1319100212    | SUMITHA UNNIKRISSHANN NAIR    | OPEN-General | 2610000035 |
| 11      | Round-VI  | 1319100649    | ARSHEE MUJEEB SAYED           | OPEN-General | 2700000053 |
| 12      | Round-VI  | 1319100802    | MALKA FIROZ AHMED             | OPEN-General | 2700000059 |
| 13      | Round-VI  | 1319100060    | MEENAKSHI GURUNATH KHARAT     | OPEN-General | 2610000047 |

Export

| Course Name                 | Grant Type | Academic Year From | Academic Year To | Course Year | Fee Type        | Annual Fee | Exam Month | Status   |
|-----------------------------|------------|--------------------|------------------|-------------|-----------------|------------|------------|----------|
| Bachelor of Education(B.ed) | UnAided    | 2018               | 2019             | 1-Year      | Tuition Fees    | 28009      | -          | Approved |
| Bachelor of Education(B.ed) | UnAided    | 2018               | 2019             | 1-Year      | Development Fee | 1961       | -          | Approved |
| Bachelor of Education(B.ed) | UnAided    | 2018               | 2019             | 1-Year      | Exam Fee        | 1450       | -          | Approved |
| Bachelor of Education(B.ed) | UnAided    | 2018               | 2019             | 1-Year      | Admission Fee   | 50         | -          | Approved |
| Bachelor of Education(B.ed) | UnAided    | 2018               | 2019             | 1-Year      | Session Fee     | 0          | -          | Approved |
| Bachelor of Education(B.ed) | UnAided    | 2018               | 2019             | 1-Year      | Laboratory Fee  | 250        | -          | Approved |
| Bachelor of Education(B.ed) | UnAided    | 2018               | 2019             | 1-Year      | Semester Fee    | 0          | -          | Approved |
| Bachelor of Education(B.ed) | UnAided    | 2018               | 2019             | 1-Year      | Library Fee     | 500        | -          | Approved |
| Bachelor of Education(B.ed) | UnAided    | 2018               | 2019             | 1-Year      | Gymkhana Fee    | 125        | -          | Approved |
| Bachelor of Education(B.ed) | UnAided    | 2018               | 2019             | 1-Year      | Study Tour      | 0          | -          | Approved |
| Bachelor of Education(B.ed) | UnAided    | 2018               | 2019             | 1-Year      | Enrollment Fee  | 220        | -          | Approved |
| Bachelor of Education(B.ed) | UnAided    | 2018               | 2019             | 1-Year      | Other Fee       | 0          | -          | Approved |
| Bachelor of Education(B.ed) | UnAided    | 2018               | 2019             | 1-Year      | Project Fee     | 0          | -          | Approved |
| M.Ed. (2-Year Course)       | UnAided    | 2018               | 2019             | 1-Year      | Tuition Fees    | 31763      | -          | Approved |
| M.Ed. (2-Year Course)       | UnAided    | 2018               | 2019             | 1-Year      | Development Fee | 2224       | -          | Approved |
| M.Ed. (2-Year Course)       | UnAided    | 2018               | 2019             | 1-Year      | Exam Fee        | 3120       | -          | Approved |
| M.Ed. (2-Year Course)       | UnAided    | 2018               | 2019             | 1-Year      | Admission Fee   | 250        | -          | Approved |
| M.Ed. (2-Year Course)       | UnAided    | 2018               | 2019             | 1-Year      | Session Fee     | 250        | -          | Approved |
| M.Ed. (2-Year Course)       | UnAided    | 2018               | 2019             | 1-Year      | Laboratory Fee  | 250        | -          | Approved |
| M.Ed. (2-Year Course)       | UnAided    | 2018               | 2019             | 1-Year      | Semester Fee    | 0          | -          | Approved |
| M.Ed. (2-Year Course)       | UnAided    | 2018               | 2019             | 1-Year      | Library Fee     | 1000       | -          | Approved |
| M.Ed. (2-Year Course)       | UnAided    | 2018               | 2019             | 1-Year      | Gymkhana Fee    | 250        | -          | Approved |
| M.Ed. (2-Year Course)       | UnAided    | 2018               | 2019             | 1-Year      | Study Tour      | 0          | -          | Approved |
| M.Ed. (2-Year Course)       | UnAided    | 2018               | 2019             | 1-Year      | Enrollment Fee  | 220        | -          | Approved |
| M.Ed. (2-Year Course)       | UnAided    | 2018               | 2019             | 1-Year      | Other Fee       | 0          | -          | Approved |
| M.Ed. (2-Year Course)       | UnAided    | 2018               | 2019             | 1-Year      | Project Fee     | 500        | -          | Approved |
| M.Ed. (2-Year Course)       | UnAided    | 2018               | 2019             | 2-Year      | Project Fee     | 1000       | -          | Approved |
| M.Ed. (2-Year Course)       | UnAided    | 2018               | 2019             | 2-Year      | Other Fee       | 0          | -          | Approved |
| M.Ed. (2-Year Course)       | UnAided    | 2018               | 2019             | 2-Year      | Enrollment Fee  | 0          | -          | Approved |
| M.Ed. (2-Year Course)       | UnAided    | 2018               | 2019             | 2-Year      | Study Tour      | 0          | -          | Approved |
| M.Ed. (2-Year Course)       | UnAided    | 2018               | 2019             | 2-Year      | Gymkhana Fee    | 250        | -          | Approved |
| M.Ed. (2-Year Course)       | UnAided    | 2018               | 2019             | 2-Year      | Library Fee     | 1000       | -          | Approved |
| M.Ed. (2-Year Course)       | UnAided    | 2018               | 2019             | 2-Year      | Semester Fee    | 0          | -          | Approved |
| M.Ed. (2-Year Course)       | UnAided    | 2018               | 2019             | 2-Year      | Laboratory Fee  | 250        | -          | Approved |
| M.Ed. (2-Year Course)       | UnAided    | 2018               | 2019             | 2-Year      | Session Fee     | 0          | -          | Approved |
| M.Ed. (2-Year Course)       | UnAided    | 2018               | 2019             | 2-Year      | Admission Fee   | 0          | -          | Approved |
| M.Ed. (2-Year Course)       | UnAided    | 2018               | 2019             | 2-Year      | Exam Fee        | 3120       | -          | Approved |
| M.Ed. (2-Year Course)       | UnAided    | 2018               | 2019             | 2-Year      | Development Fee | 2223       | -          | Approved |
| M.Ed. (2-Year Course)       | UnAided    | 2018               | 2019             | 2-Year      | Tuition Fees    | 31762      | -          | Approved |
| Bachelor of Education(B.ed) | UnAided    | 2018               | 2019             | 2-Year      | Project Fee     | 270        | -          | Approved |
| Bachelor of Education(B.ed) | UnAided    | 2018               | 2019             | 2-Year      | Other Fee       | 0          | -          | Approved |
| Bachelor of Education(B.ed) | UnAided    | 2018               | 2019             | 2-Year      | Enrollment Fee  | 0          | -          | Approved |
| Bachelor of Education(B.ed) | UnAided    | 2018               | 2019             | 2-Year      | Study Tour      | 0          | -          | Approved |
| Bachelor of Education(B.ed) | UnAided    | 2018               | 2019             | 2-Year      | Gymkhana Fee    | 125        | -          | Approved |
| Bachelor of Education(B.ed) | UnAided    | 2018               | 2019             | 2-Year      | Library Fee     | 500        | -          | Approved |
| Bachelor of Education(B.ed) | UnAided    | 2018               | 2019             | 2-Year      | Semester Fee    | 0          | -          | Approved |
| Bachelor of Education(B.ed) | UnAided    | 2018               | 2019             | 2-Year      | Laboratory Fee  | 250        | -          | Approved |
| Bachelor of Education(B.ed) | UnAided    | 2018               | 2019             | 2-Year      | Session Fee     | 0          | -          | Approved |
| Bachelor of Education(B.ed) | UnAided    | 2018               | 2019             | 2-Year      | Admission Fee   | 0          | -          | Approved |
| Bachelor of Education(B.ed) | UnAided    | 2018               | 2019             | 2-Year      | Exam Fee        | 1450       | -          | Approved |
| Bachelor of Education(B.ed) | UnAided    | 2018               | 2019             | 2-Year      | Development Fee | 1961       | -          | Approved |
| Bachelor of Education(B.ed) | UnAided    | 2018               | 2019             | 2-Year      | Tuition Fees    | 28009      | -          | Approved |
| Bachelor of Education(B.ed) | UnAided    | 2019               | 2020             | 1-Year      | Tuition Fees    | 61000      | -          | Approved |
| Bachelor of Education(B.ed) | UnAided    | 2019               | 2020             | 1-Year      | Development Fee | 2500       | -          | Approved |
| Bachelor of Education(B.ed) | UnAided    | 2019               | 2020             | 1-Year      | Exam Fee        | 1000       | -          | Approved |
| Bachelor of Education(B.ed) | UnAided    | 2019               | 2020             | 1-Year      | Admission Fee   | 500        | -          | Approved |
| Bachelor of Education(B.ed) | UnAided    | 2019               | 2020             | 1-Year      | Session Fee     | 0          | -          | Approved |
| Bachelor of Education(B.ed) | UnAided    | 2019               | 2020             | 1-Year      | Laboratory Fee  | 350        | -          | Approved |
| Bachelor of Education(B.ed) | UnAided    | 2019               | 2020             | 1-Year      | Semester Fee    | 0          | -          | Approved |
| Bachelor of Education(B.ed) | UnAided    | 2019               | 2020             | 1-Year      | Library Fee     | 500        | -          | Approved |
| Bachelor of Education(B.ed) | UnAided    | 2019               | 2020             | 1-Year      | Gymkhana Fee    | 150        | -          | Approved |
| Bachelor of Education(B.ed) | UnAided    | 2019               | 2020             | 1-Year      | Study Tour      | 0          | -          | Approved |
| Bachelor of Education(B.ed) | UnAided    | 2019               | 2020             | 1-Year      | Enrollment Fee  | 0          | -          | Approved |
| Bachelor of Education(B.ed) | UnAided    | 2019               | 2020             | 1-Year      | Other Fee       | 500        | -          | Approved |
| Bachelor of Education(B.ed) | UnAided    | 2019               | 2020             | 1-Year      | Project Fee     | 500        | -          | Approved |
| M.Ed. (2-Year Course)       | UnAided    | 2019               | 2020             | 1-Year      | Tuition Fees    | 63150      | -          | Approved |
| M.Ed. (2-Year Course)       | UnAided    | 2019               | 2020             | 1-Year      | Development Fee | 2500       | -          | Approved |
| M.Ed. (2-Year Course)       | UnAided    | 2019               | 2020             | 1-Year      | Exam Fee        | 1700       | -          | Approved |
| M.Ed. (2-Year Course)       | UnAided    | 2019               | 2020             | 1-Year      | Admission Fee   | 500        | -          | Approved |
| M.Ed. (2-Year Course)       | UnAided    | 2019               | 2020             | 1-Year      | Session Fee     | 0          | -          | Approved |
| M.Ed. (2-Year Course)       | UnAided    | 2019               | 2020             | 1-Year      | Laboratory Fee  | 500        | -          | Approved |
| M.Ed. (2-Year Course)       | UnAided    | 2019               | 2020             | 1-Year      | Semester Fee    | 0          | -          | Approved |
| M.Ed. (2-Year Course)       | UnAided    | 2019               | 2020             | 1-Year      | Library Fee     | 500        | -          | Approved |
| M.Ed. (2-Year Course)       | UnAided    | 2019               | 2020             | 1-Year      | Gymkhana Fee    | 150        | -          | Approved |
| M.Ed. (2-Year Course)       | UnAided    | 2019               | 2020             | 1-Year      | Study Tour      | 0          | -          | Approved |
| M.Ed. (2-Year Course)       | UnAided    | 2019               | 2020             | 1-Year      | Enrollment Fee  | 0          | -          | Approved |

|                             |         |      |      |        |                 |       |   |          |
|-----------------------------|---------|------|------|--------|-----------------|-------|---|----------|
| M.Ed. (2-Year Course)       | UnAided | 2019 | 2020 | 1-Year | Other Fee       | 0     | - | Approved |
| M.Ed. (2-Year Course)       | UnAided | 2019 | 2020 | 1-Year | Project Fee     | 500   | - | Approved |
| M.Ed. (2-Year Course)       | UnAided | 2019 | 2020 | 2-Year | Project Fee     | 1000  | - | Approved |
| M.Ed. (2-Year Course)       | UnAided | 2019 | 2020 | 2-Year | Other Fee       | 0     | - | Approved |
| M.Ed. (2-Year Course)       | UnAided | 2019 | 2020 | 2-Year | Enrollment Fee  | 0     | - | Approved |
| M.Ed. (2-Year Course)       | UnAided | 2019 | 2020 | 2-Year | Study Tour      | 0     | - | Approved |
| M.Ed. (2-Year Course)       | UnAided | 2019 | 2020 | 2-Year | Gymkhana Fee    | 150   | - | Approved |
| M.Ed. (2-Year Course)       | UnAided | 2019 | 2020 | 2-Year | Library Fee     | 750   | - | Approved |
| M.Ed. (2-Year Course)       | UnAided | 2019 | 2020 | 2-Year | Semester Fee    | 0     | - | Approved |
| M.Ed. (2-Year Course)       | UnAided | 2019 | 2020 | 2-Year | Laboratory Fee  | 750   | - | Approved |
| M.Ed. (2-Year Course)       | UnAided | 2019 | 2020 | 2-Year | Session Fee     | 0     | - | Approved |
| M.Ed. (2-Year Course)       | UnAided | 2019 | 2020 | 2-Year | Admission Fee   | 0     | - | Approved |
| M.Ed. (2-Year Course)       | UnAided | 2019 | 2020 | 2-Year | Exam Fee        | 1700  | - | Approved |
| M.Ed. (2-Year Course)       | UnAided | 2019 | 2020 | 2-Year | Development Fee | 2224  | - | Approved |
| M.Ed. (2-Year Course)       | UnAided | 2019 | 2020 | 2-Year | Tuition Fees    | 31763 | - | Approved |
| Bachelor of Education(B.ed) | UnAided | 2019 | 2020 | 2-Year | Project Fee     | 1000  | - | Approved |
| Bachelor of Education(B.ed) | UnAided | 2019 | 2020 | 2-Year | Other Fee       | 850   | - | Approved |
| Bachelor of Education(B.ed) | UnAided | 2019 | 2020 | 2-Year | Enrollment Fee  | 0     | - | Approved |
| Bachelor of Education(B.ed) | UnAided | 2019 | 2020 | 2-Year | Study Tour      | 0     | - | Approved |
| Bachelor of Education(B.ed) | UnAided | 2019 | 2020 | 2-Year | Gymkhana Fee    | 150   | - | Approved |
| Bachelor of Education(B.ed) | UnAided | 2019 | 2020 | 2-Year | Library Fee     | 500   | - | Approved |
| Bachelor of Education(B.ed) | UnAided | 2019 | 2020 | 2-Year | Semester Fee    | 0     | - | Approved |
| Bachelor of Education(B.ed) | UnAided | 2019 | 2020 | 2-Year | Laboratory Fee  | 500   | - | Approved |
| Bachelor of Education(B.ed) | UnAided | 2019 | 2020 | 2-Year | Session Fee     | 0     | - | Approved |
| Bachelor of Education(B.ed) | UnAided | 2019 | 2020 | 2-Year | Admission Fee   | 0     | - | Approved |
| Bachelor of Education(B.ed) | UnAided | 2019 | 2020 | 2-Year | Exam Fee        | 1000  | - | Approved |
| Bachelor of Education(B.ed) | UnAided | 2019 | 2020 | 2-Year | Development Fee | 1961  | - | Approved |
| Bachelor of Education(B.ed) | UnAided | 2019 | 2020 | 2-Year | Tuition Fees    | 28009 | - | Approved |